



shadowspec

umbrellas with distinction

SU7

ROTATING CANTILEVER UMBRELLA

OWNERS MANUAL

Installation, Operation, Care and Warranty



CONTENTS

Page

SECTION 1 - Assembly, Installation & Operation 3

Stage 1 - Umbrella Location 3

Stage 1A - Planning the Umbrella Location 3

Stage 2 - Installation of the Umbrella Fixing 5

Option 1 - Portable Steel Base 5

Option 2 - In-Ground Anchor Fixing 6

Option 3 - Surface Plate Fixing 8

Option 4 - Wall Anchor Fixing 10

Stage 3 - Assembling & Mounting the Umbrella 12

Stage 3A - Assembling the Umbrella 12

Stage 3B - Mounting the Umbrella 12

Stage 3C - Fixing the Fabric Canopy to Umbrella Frame 16

Stage 3D - Connecting the LED Lights (optional accessory) 17

Stage 3E - Fitting the LED Light System (optional accessory) 18

Stage 4 - Operating the Umbrella 20

SECTION 2 - Umbrella Care & Maintenance 21

SECTION 3 - Warranty 22

SECTION 1 – Assembly, Installation & Operation

STAGE 1 Umbrella Location

1A) PLANNING THE UMBRELLA LOCATION:

Special care is needed when selecting the best location for your umbrella.
Some key points to keep in mind are:

Ensure that the location you have chosen has the umbrella in a position where it provides the best possible coverage over the area that you want shaded.

Remember the SU7 has the ability to rotate 360° so if you wish to utilise this function ensure that you allow the necessary space around the umbrella for this. (see Figure 1).

Figure 1 - SU7 Umbrella Configurations, Area Coverage and Dimensions

Configurations/Area Coverage:

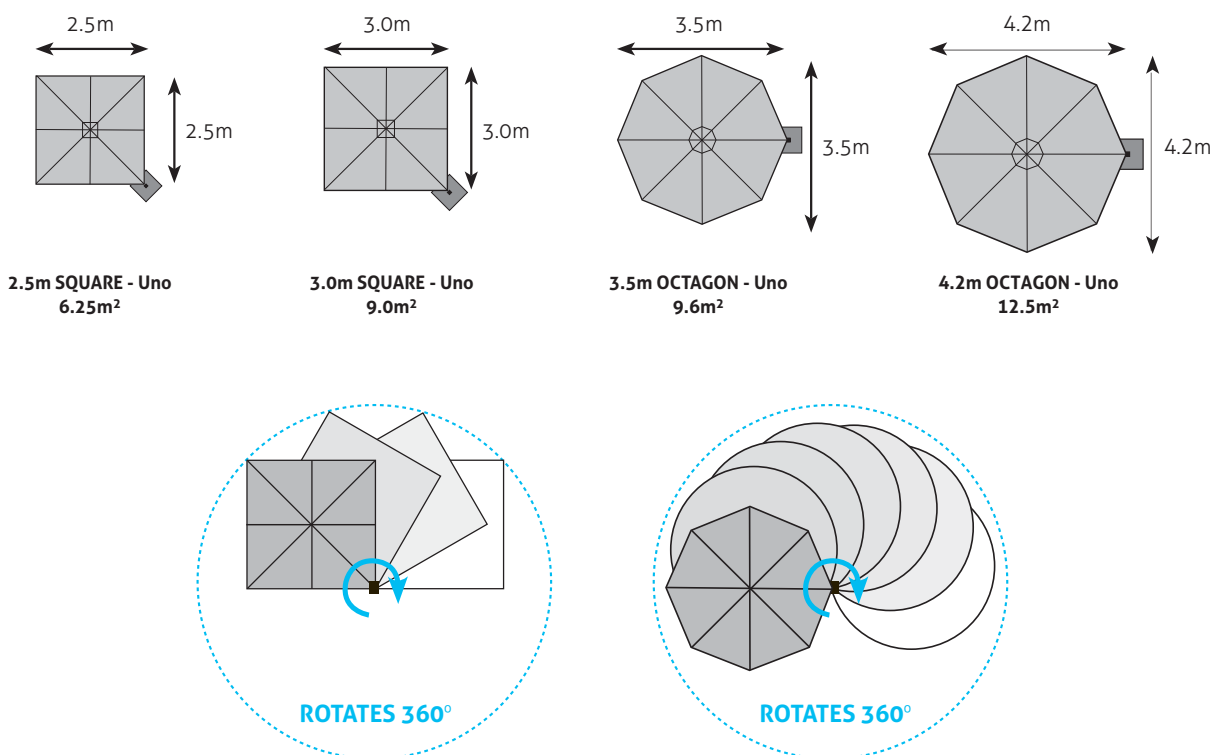
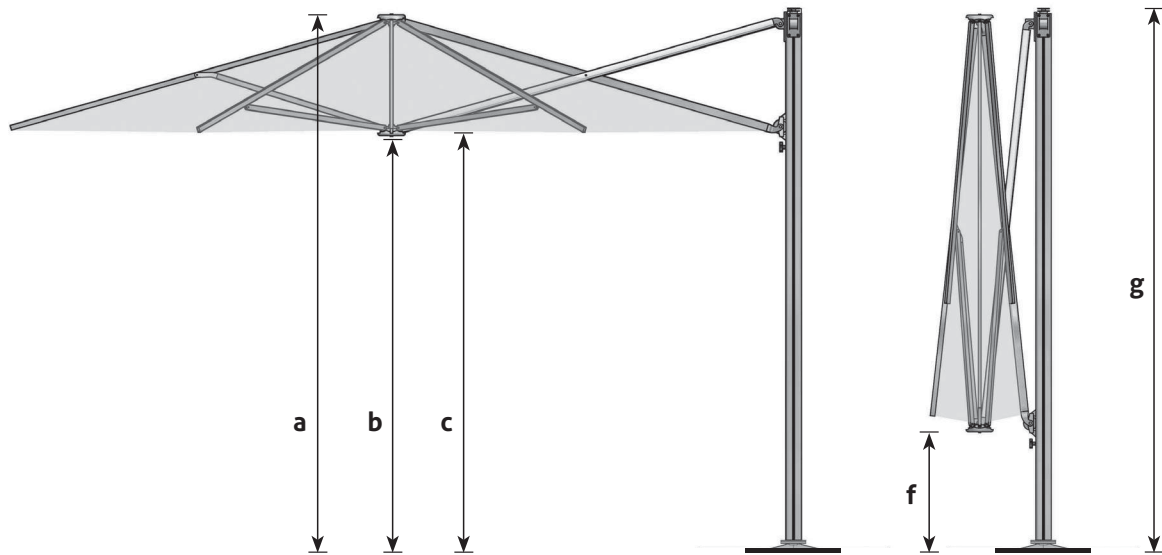

Figure 1 continued next page....



Figure 1 cont...

Key Dimensions (excludes portable base - portable base increases height dimensions by 12cm):



	2.5m Square	3.0m Square	3.5m Octagon	4.2m Octagon
Dimensions of open umbrella				
a: Total height to top of canopy (cm)	+/- 278	+/- 278	+/- 278	+/- 278
b: Distance from ground to central frame hub (cm)	+/- 212	+/- 212	+/- 212	+/- 212
c: Height to lower outer edge of canopy (cm)	+/- 217	+/- 217	+/- 217	+/- 217
d: Distance from centre of mast to outside edge of canopy (cm)**	+/- 257	+/- 307	+/- 363	+/- 436
e: Diagonal distance from centre of mast to opposite / furthest corner of umbrella (diameter) (cm)**	+/- 363	+/- 436	+/- 363	+/- 436
Dimensions of closed umbrella				
f: Distance from ground to central frame hub (cm)	+/- 78	+/- 42	+/- 78	+/- 42
g: Overall height of umbrella to top of mast cap (cm)	+/- 276	+/- 276	+/- 276	+/- 276

** Refer plan diagrams in table.

STAGE 2 Installation of the Umbrella Fixing

IMPORTANT TIP! On the base plate of the mast support there is a small protruding nipple (see Figure 2) which acts as a stopper, preventing the umbrella mast from rotating past a 300° radius. Should your umbrella be fitted with the optional LED light, this nipple is a necessary feature to prevent the electrical cable housed inside the mast from becoming twisted. However, if your umbrella is not fitted with the optional LED light, this nipple is not necessary and can be easily removed using a hammer and nail punch or similar, thus enabling the umbrella to rotate a full 360°.

Figure 2 - Position of rotational stopper nipple.

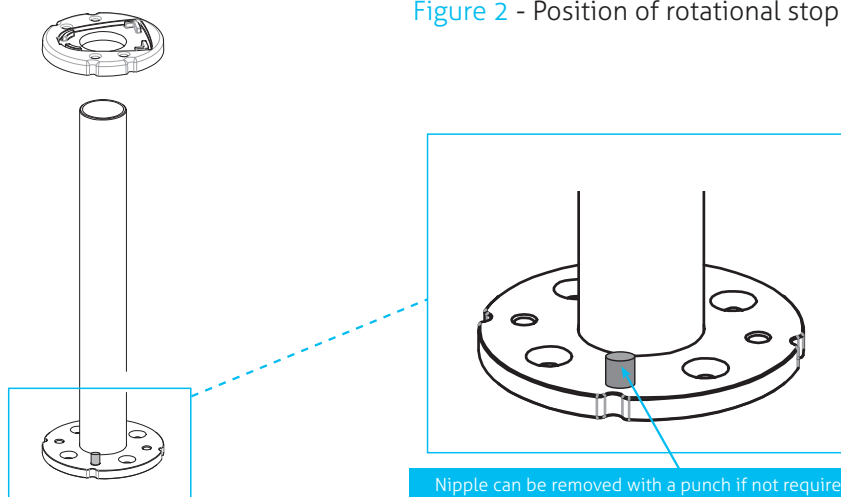

Option 1 - PORTABLE STEEL BASE

For installation you will require:

- 1 person
- Adjustable spanner
- Hex Allen key set
- The complete Portable Steel Base kit (see below - follow the indications on the diagram to install the necessary parts).

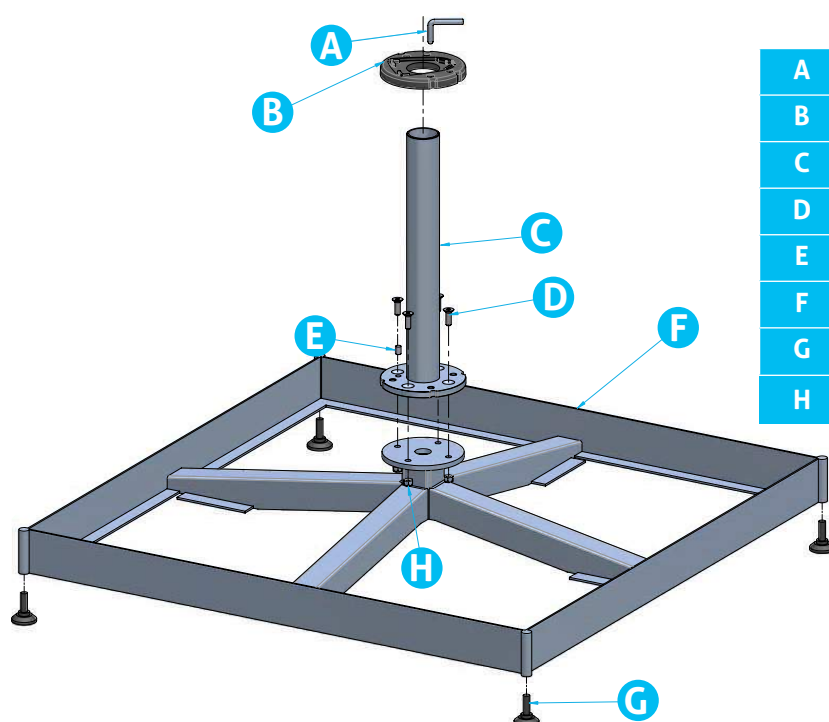

A	Rotational Locking Pin (x1)
B	Rotating Platform (x1)
C	Main mast support spigot (x1)
D	M8 70mm Bolts countersunk (x4)
E	Rotating Stopper Nipple (x1)
F	Portable Steel base (x1)
G	Threaded foot screws (x4)
H	Nuts (x4)

Wheels Option:

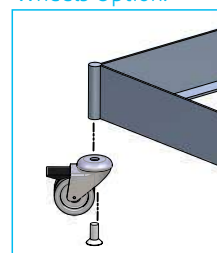



Option 2 - IN-GROUND ANCHOR FIXING

For installation you will require:

- 1 person
- Concrete mix, spade and a wheelbarrow
- Hex Allen key set
- The complete In-ground Anchor kit (see Figure 3).

Figure 3 - In-Ground Anchor kit for SU7 Umbrella*

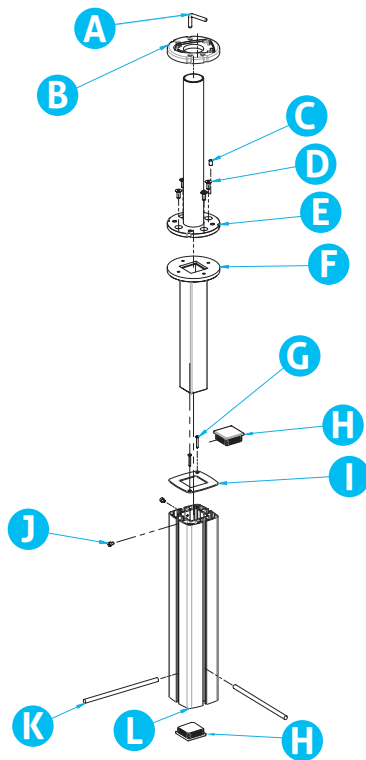

A	Rotational Locking Pin (x1)
B	Rotating Platform (x1)
C	Rotating Stopper Nipple (x1)
D	M8 20mm Screws (x4)
E	Main mast support spigot (x1)
F	Main mast support foot (x2)
G	4.2mm x 32mm Screws (x2)
H	Square hole plug (x2)
I	Capping plate
J	M6 x 8.0mm Allen screws (x2)
K	Threaded foundation rods (x2)
L	Main In-ground Fitting (x1)

* Please note that the Main In-ground Fitting (L) is generally supplied semi-assembled.

Step 1 Choose your site carefully – ensure ground is level and that there is no risk of damaging underground utilities when you start digging.

Step 2 Dig your footing hole at least 500mmW x 500mmL x 700mmH**. It is recommended that you flare the footing hole slightly at the base for extra stability (see Figure 4).

** Please note that the dimensions stated in Step 2 above are given as a guide only. Footing requirements can differ depending on the ground composition at your property. For instance, if you are installing the anchor into topsoil or sand a larger hole may be necessary and it is best if you seek appropriate advice in regards to this. Remember the depth of the hole is just as important as the width and it is simpler to increase the size of the footing than to try and relocate it or re-stabilize it should it start to move over time. When pouring the concrete it is also advisable to insert some lengths of reinforcing steel bar into the hole to strengthen the concrete and help prevent it from cracking.

Step 3 Insert 10mm diameter Foundation Rods (K) into Main In-ground Fitting (L) (see Figure 4).

Step 4 Mix and prepare the concrete ready to pour into the hole.

Step 5 Position the Main In-ground Fitting (**K+L**) in the hole ensuring that it is level/perpendicular. Scallop out a small cove in the concrete for access to screws (**J**) at the top of the Main In-ground Fitting (**K**) (see Figure 4). It is recommended that the Main Mast Support Foot (**F**) and the Main Mast Support Spigot (**E**) are assembled to the Main In-ground Fitting (**L**) to assist getting it level / perpendicular.

HANDY TIP! To avoid excess concrete travelling up into the centre of the fitting please ensure that you close off the bottom of the fitting using plastic hole plug provided before positioning it in the hole.

Step 6 Pour concrete into the hole around the fitting and up to the required finished level. (Note: extra props / support may be required to ensure that the Fitting remains level while the concrete sets).

HANDY TIP! Before leaving the concrete to cure re-check the fitting to ensure that it is level/perpendicular.

Step 7 Once the concrete is fully cured, the umbrella mast can be placed onto the Main Support Spigot (**E**).

Figure 4 - In-Ground Anchor installation & suggested specifications for SU7 Umbrella

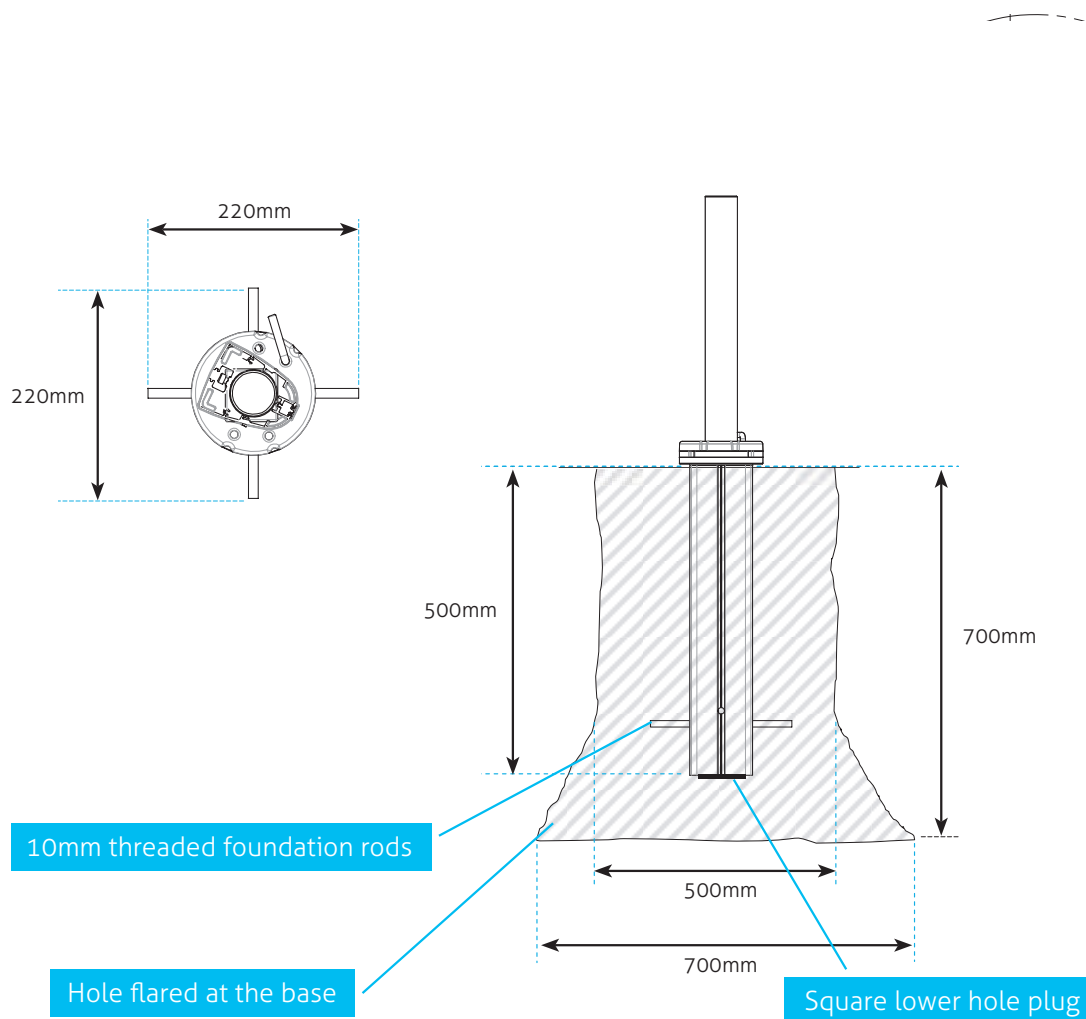



Option 3 - SURFACE PLATE FIXING

For installation you will require:

- 1 person
- 4 x 10mmØ bolts (not supplied - the type of bolts you need and the length will depend on what type of surface you are fixing the Surface Plate to and the surrounding environment)
- Hex Allen key set
- 2x adjustable spanner/wrench
- The complete Surface Plate Anchor kit (see Figure 5).

Figure 5 - Surface Plate Anchor kit for SU7 Umbrella

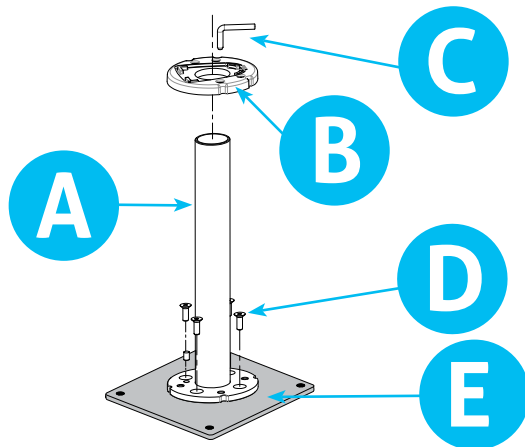

A	Spigot (x1)
B	Rotating Platform (x1)
C	Rotational Locking Pin (x1)
D	Spigot Mounting Bolts (provided)
E	Surface Plate Fixing (x1)
NOTE: Bolts for fixing to surface not supplied	

Step 1 Choose your site carefully – ensure the surface that you are anchoring to is clean, level and structurally sound.

HANDY TIP! It is recommended to double check the mounting surface is level by placing the surface plate where you want it to be located and ensuring that the spigot is perfectly vertical/perpendicular.

Step 2 Place the Surface Plate where you want it to be located.

Step 3 Mark the position of the four bolt holes on the surface that you are fixing to.

HANDY TIP! If you are mounting the Surface Plate to a wooden deck it is essential that all four fixing bolts (not supplied), are secured through the substantial structure of the deck and not only to the deck planking. In order to achieve this some additional structural bracing may be required before the surface plate can be fitted securely (as a suggestion see Figure 6).

HANDY TIP! If you are securing the Surface Plate to a wooden deck it is also recommended that you place a washer between the bottom of the plate and the surface of the deck, this leaves a small gap to allow water to escape and reduce the risk of long-term water damage to the deck (See Figure 6).

Step 4 Drill holes and secure the surface plate using the 4 x 10mmØ bolts (not supplied - the type of bolts you need and the length will depend on what type of surface you are fixing the surface plate to and the surrounding environment)

Step 5 Using bolts provided, fix spigot to the surface plate. Ensure that it is correctly orientated regarding the position of the rotational stopper nipple (refer Figure 2) if still in place.

Step 6 Once the spigot and the surface plate are secure, lower the rotating platform over the spigot, and insert the locking pin as preferred. Once complete, the umbrella mast can be placed onto the Main Mast Support Spigot.

Figure 6 - Securing SU7 Surface Plate Fixing to wooden deck (suggestion only)

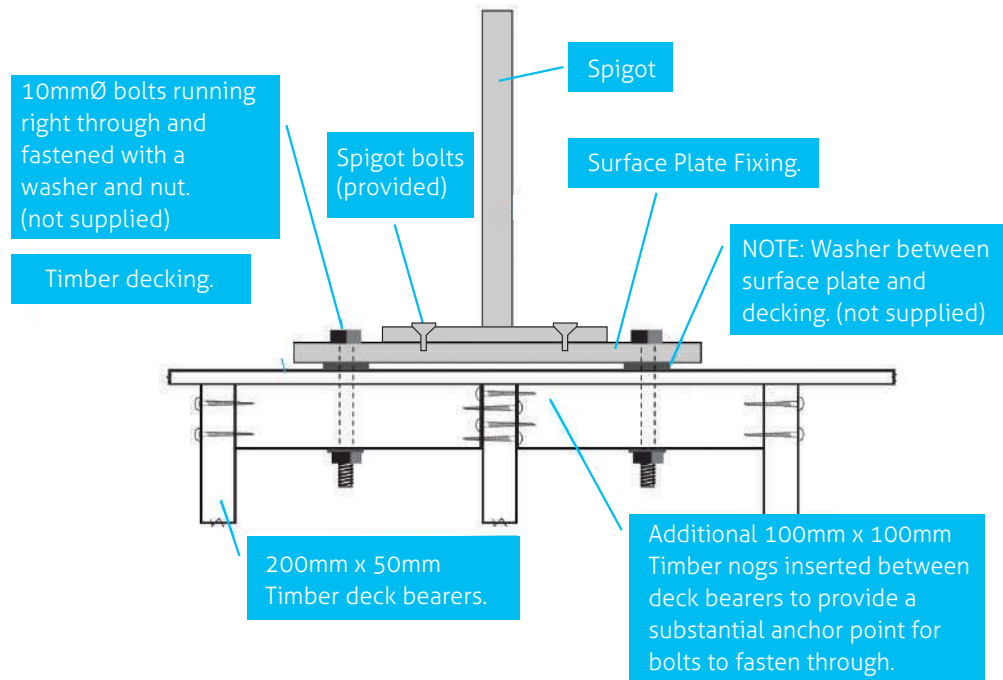

HANDY TIP! If you are securing the surface plate to an existing concrete pad it is important that you know the thickness of the concrete before you begin. It is recommended that the concrete be at least 100mm deep and that no screws or fixings be within 150mm of closest edge of concrete (See Figure 7).

Figure 7 - Securing SU7 Surface Plate Fixing to concrete slab (suggestion only)

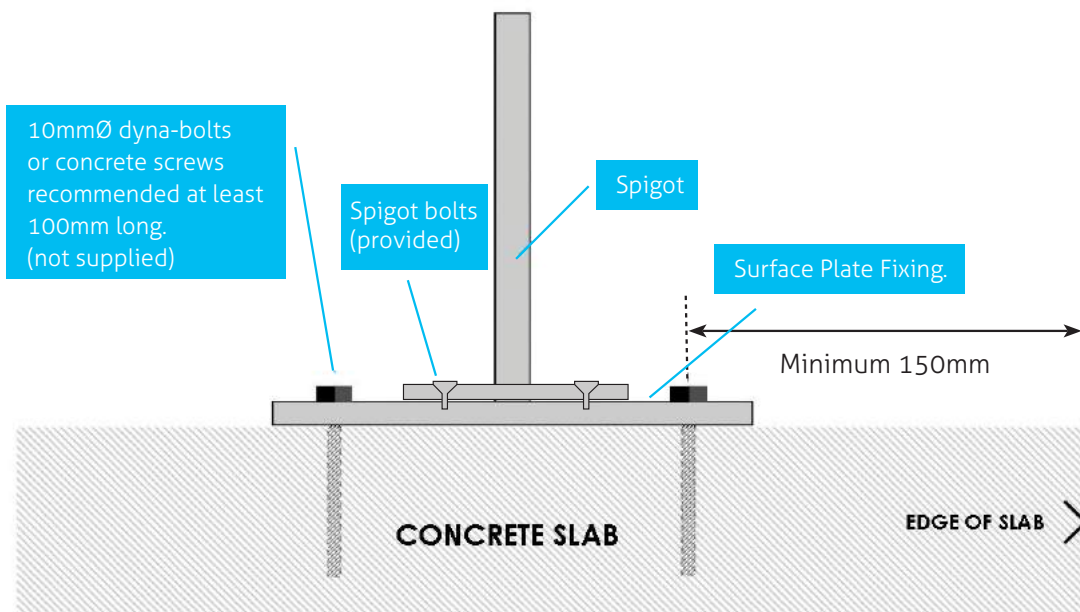

Recommended minimum depth of concrete slab 100mm.
NOTE: No screws or fixings to be within 150mm of closest edge of concrete slab.



Option 4 - WALL ANCHOR FIXING

For installation you will require:

- 1 person
- 8x screws/bolts (not supplied - the type of fastenings you need and the length will depend on the type of surface you are fixing the Wall Anchor to and the surrounding environment)
- Hex Allen key set
- 2x adjustable spanner/wrench
- The two Wall Anchor Fixing brackets (see Figure 8).

Figure 8 - Wall Fixing Anchor brackets for SU7 Umbrella

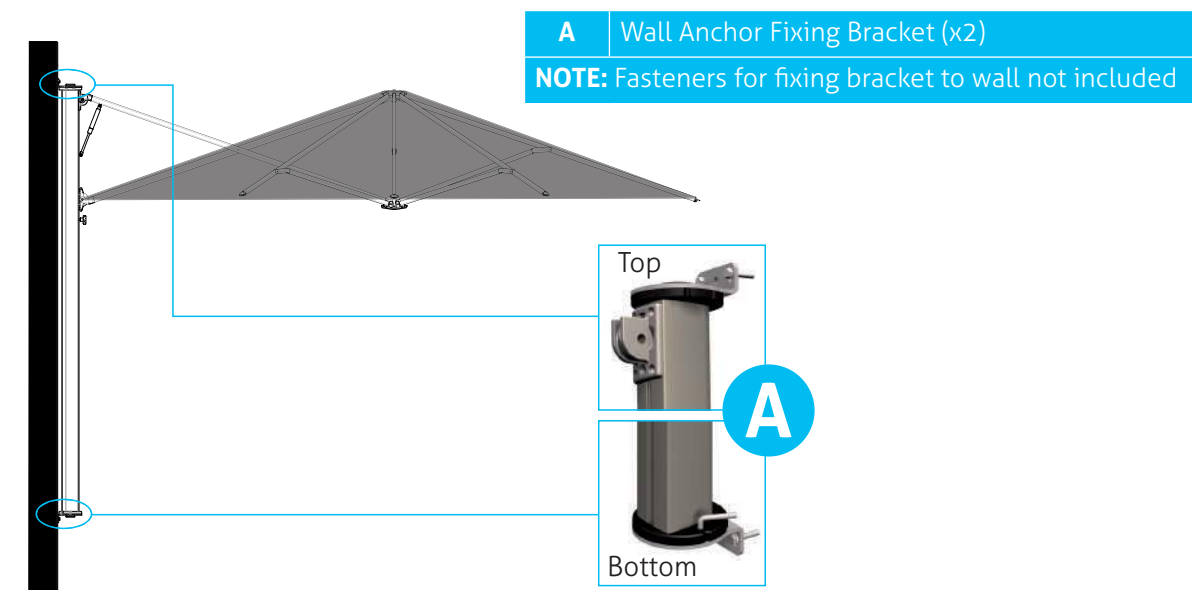

Step1 Choose your site carefully – ensure the surface that you are anchoring to is clean, structurally sound and has sufficient height to accommodate the height of the umbrella mast.

HANDY TIP! Fastening requirements will differ depending on the type of wall structure that you are fixing the Wall Anchor brackets to. It is recommended that you seek appropriate advice in regards to this in order to ensure that your umbrella is mounted securely.

Step2 Before you begin the next step of securing the Wall Anchor Fixing brackets to the wall you will need to complete steps 1-4 of assembling the umbrella (refer to STAGE 3, 3A - Assembling The Umbrella & Figure 9). Also if your umbrella is fitted with the optional LED light, you will need to complete steps 1 & 2 of Connecting the LED Light (refer to STAGE 3, 3D - Connecting the LED Light).

HANDY TIP! Given that the umbrella mast is not sitting on the ground surface, the height positioning of the umbrella is somewhat variable and entirely up to the requirements of the user. However as a guide, it is suggested to match the 2.1m head clearance of the standard ground mounted umbrella. To achieve this, the upper Wall Anchor fixing bracket would be positioned approx 2850mm above the ground.

- Step 3** Drill holes and secure the lower Wall Anchor Fixing bracket to the wall ensuring that it is level.
- Step 4** Insert the umbrella mast onto the rotating platform of the lower Wall Anchor Fixing bracket (which is now fixed to the wall).
- Step 5** Place the rotating platform of the upper Wall Anchor Fixing bracket on the top of the mast.
- Step 6** Ensure the mast is vertical/perpendicular. Mark and drill the holes for the upper Wall Anchor Fixing bracket.
- Step 7** Leaving the mast in place between the two brackets, secure the upper Wall Anchor Fixing bracket to the wall.

The Umbrella mast should now be mounted to the wall held between the two Wall Anchor brackets. It cannot be removed without first removing one of the brackets from the wall.

Figure 9 - SU7 Wall Anchor Fixing Installation

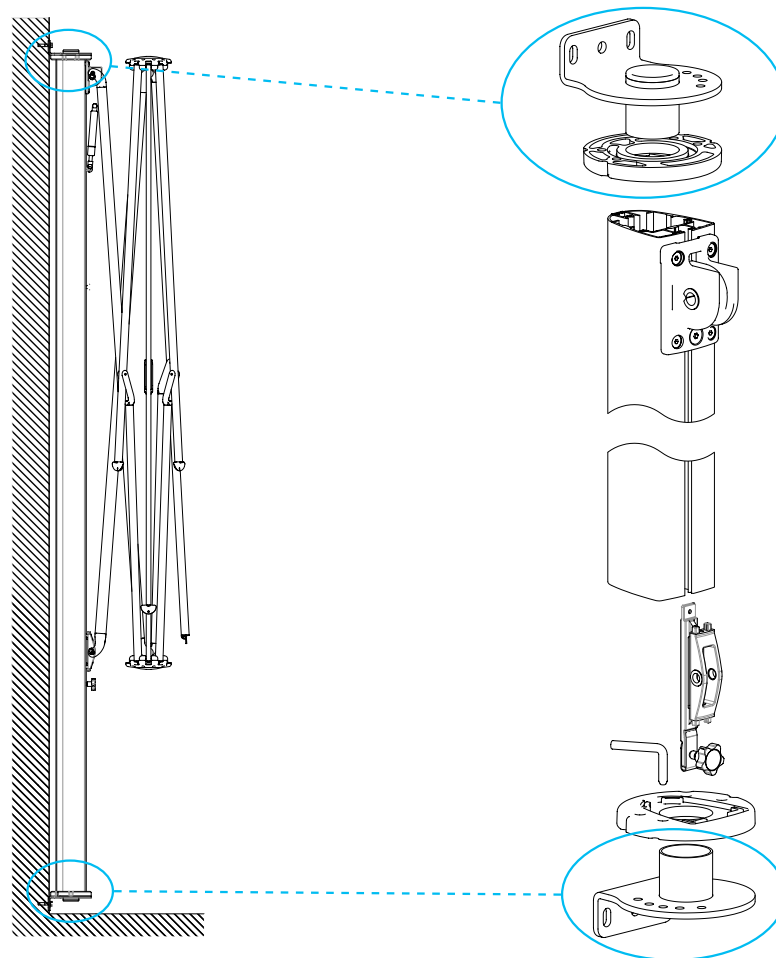



STAGE 3 Assembling and Mounting the Umbrella/s

3A) ASSEMBLING THE UMBRELLA:

For this step it is easier to remove the umbrella mast off the ground spigot/wall brackets and lay it in a horizontal position.

You will require:

- 1-2 persons
- Hex Allen key set
- 2x adjustable spanner/wrench
- The umbrella mast
- The umbrella frame/s
- The assembly parts kit (supplied with each umbrella frame) (see Figure 10)
- The umbrella canopy fabric/s (if not supplied already fitted to the umbrella frame/s)

Work through the following steps carefully referring to the diagrams (see Figure 10 and Figure 11) as you do so.

- Step 1** Lay the umbrella mast in a horizontal position on the ground or on a bench with sufficient protection to ensure that the outer surface is not scratched or damaged in any way. Insert Sliding wagon **(F)** into place on mast.
- Step 2** *(for a Wall Anchor fixing only)*
Attach the Gas Strut Support Plate **(I)** to the Frame Support **(G)**, not fully tightening the 25mm Allen screw **(H)**. Insert eye-bolt **(K)** into Gas Strut Support Plate. Slide this frame support assembly **(G+I+K)** into top of mast and line up the four holes in the Frame Support **(G)** with the four holes in top of mast. Insert the two Frame Support Back-Plates **(D)** into top of mast as shown so that the holes in each Back-Plate line up with the holes in the Frame Support **(G)** and holes in the mast. Insert the 20mm Allen screws **(C)** into the Frame Support, securing it to the mast (once completed, go directly to Step 5).
- Step 3a** *(for Surface Plate, In-Ground Anchor, Portable Base fixing options)*
Loosely attach the Frame Support Back-Plates **(D)** and Gas Strut Support Plate **(I)** to Frame Support **(G)** (note these bolts should not be fully tightened until Step 4). Insert eye-bolt **(K)** into Gas Strut Support Plate **(I)**.
- Step 3b** Slide the entire Frame Support Assembly **(D+G+I+K)** into top of mast as shown.
- Step 4** Insert the two lower screws **(C)** into the frame support securing it to the mast. Fully tighten all five screw bolts.
- Step 5** Fix upper main spar of umbrella frame to frame support using frame axle **(B)** and nuts **(A)** provided.
- Step 6** Fix lower main spar of umbrella frame to sliding wagon using frame axle **(B)** and nuts **(A)** provided.

HANDY TIP! If your umbrella includes the option of LED Lighting (see Figure 12) you will need to install the LED light system (see 3E, page 18) before proceeding with Step 7.

- Step 7** Fix moulded plastic mast cap to top of mast with screws provided.

3B) MOUNTING THE UMBRELLA:

(Note Steps 8 and 9 apply only to the In-ground Anchor or Surface Plate Fixings (not applicable to the Wall Anchor Fixing).

At this point you will also need:

- Another person (recommended)
- A step ladder

Step 8 Lift and slide Umbrella mast (now complete with frame attached) back on to the anchor spigot.

Step 9 Slide the sliding wagon (F) up the mast, raising the umbrella and lock in position once the sliding wagon (F) is approximately midway past the hole for the stopper screw (refer to Pictorial Step 12, Page 15). Lock the sliding wagon in position using the tightening wheel.

Step 10 Attach the gas strut ensuring that it is positioned the correct way up as shown.

Step 11 Once the gas strut is secure the screw stopper can be inserted in place.

Figure 10 - SU7 Parts kit - small parts identificationlist

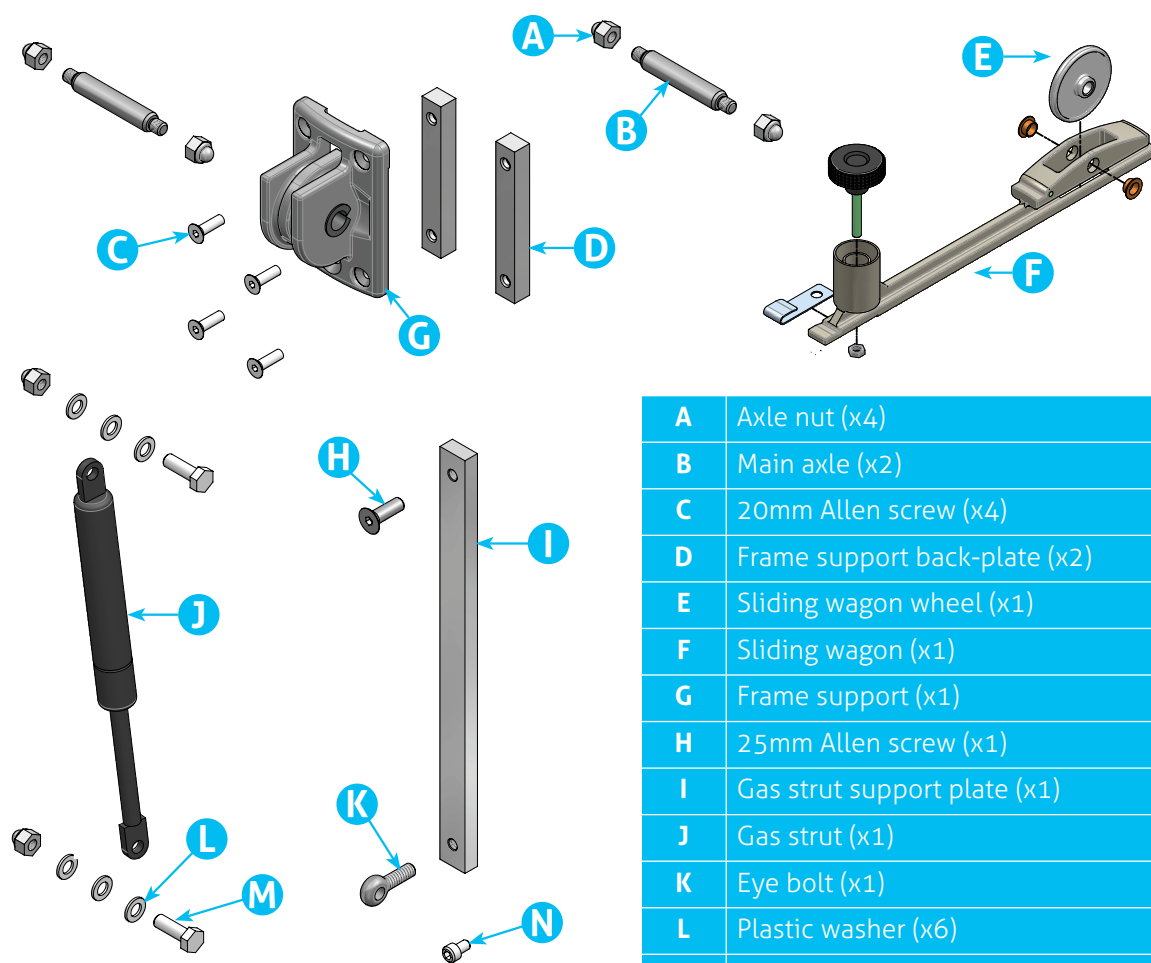

A	Axle nut (x4)
B	Main axle (x2)
C	20mm Allen screw (x4)
D	Frame support back-plate (x2)
E	Sliding wagon wheel (x1)
F	Sliding wagon (x1)
G	Frame support (x1)
H	25mm Allen screw (x1)
I	Gas strut support plate (x1)
J	Gas strut (x1)
K	Eye bolt (x1)
L	Plastic washer (x6)
M	Gas Strut mounting bolt & nut (x2)
N	Stopper screw (x1)



Figure 11 - SU7 Assembly, step by step attaching umbrella to mast

(NOTE: If your umbrella has a Surface Plate, In-ground Anchor or Portable base fixing please skip Step No.2)

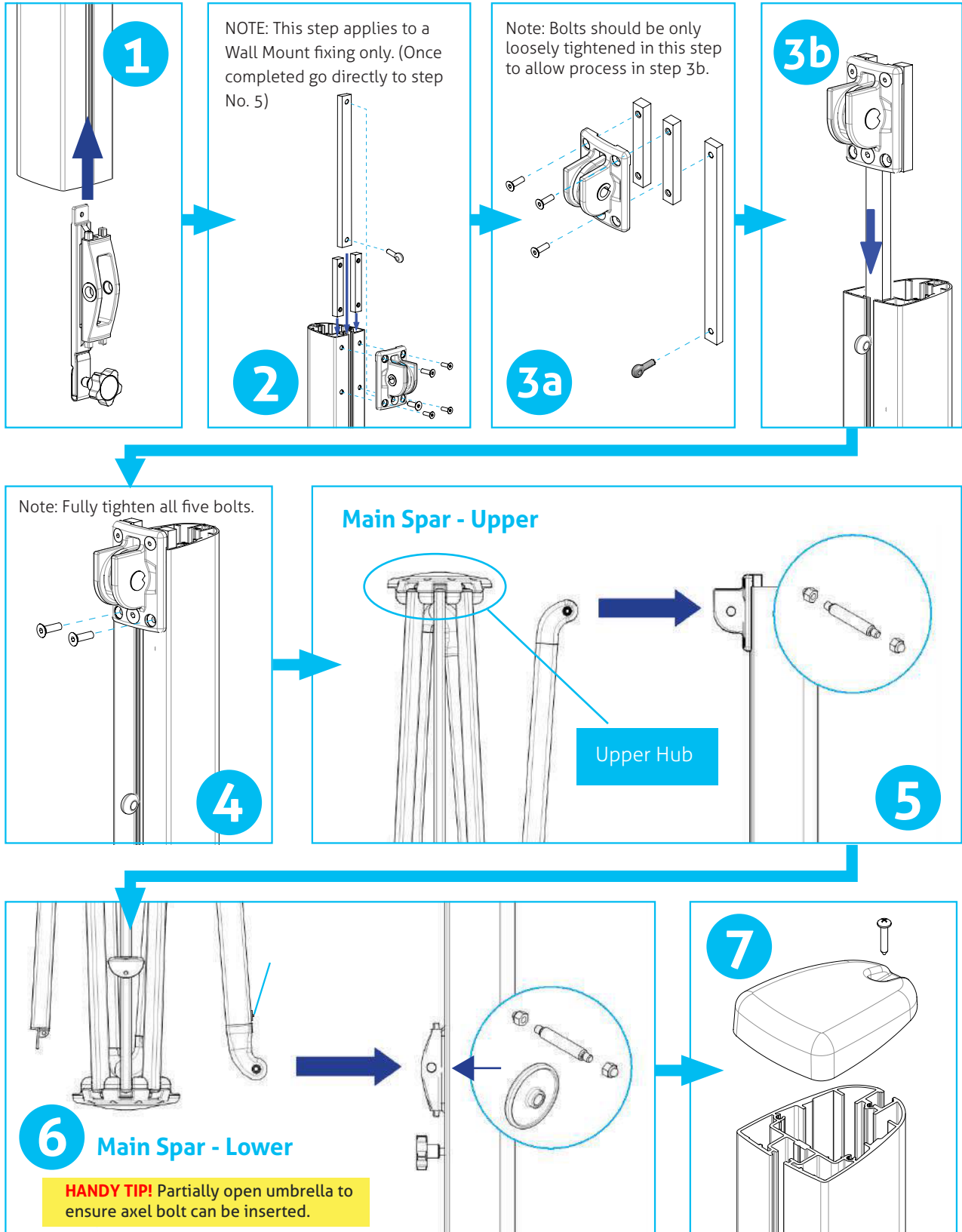

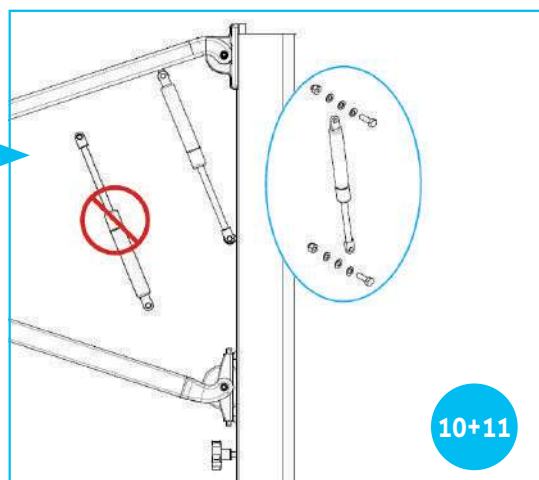
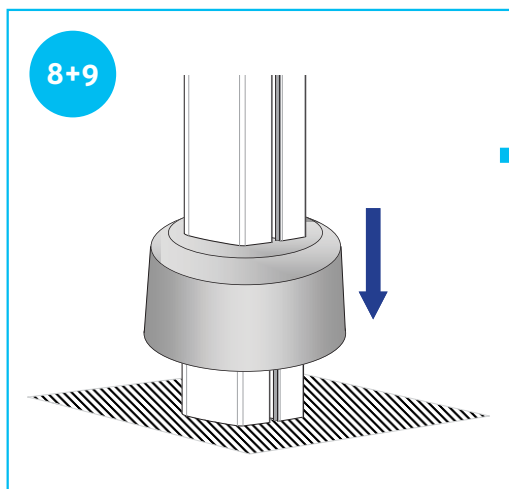

12

Upper Frame Hub
+
Fabric Canopy Cap

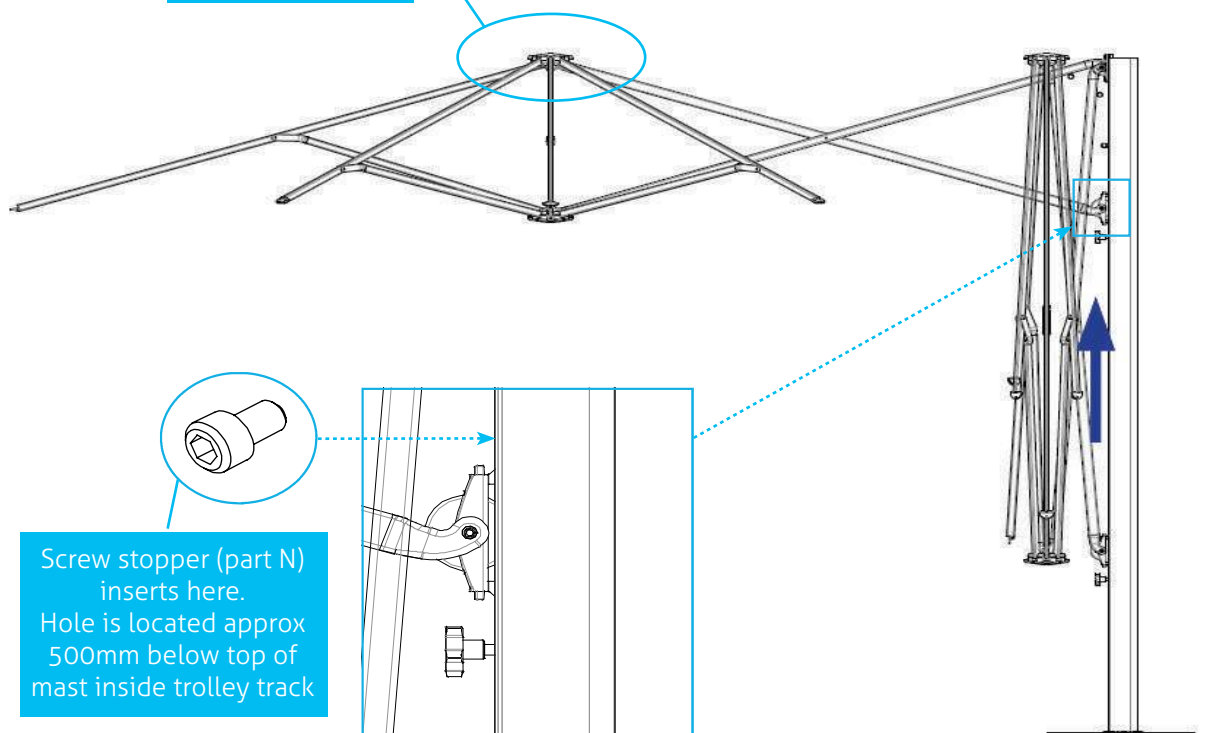



3C) FIXING THE FABRIC CANOPY TO UMBRELLA FRAME

HANDY TIP! Your Umbrella may possibly be supplied with the fabric canopy already fitted to the frame. If so, then you can simply use this section as a reference if you ever wish to remove the fabric canopy (ie: to clean it). If the fabric canopy is supplied separate to the frame, work through these simple steps to install the fabric to the frame for the first time.

- Step 1** Remove the fabric canopy from its packaging and unfold it out on a clean surface.
- Step 2** Locate the fabric corner that has the oval brass / nickel eyelet in it. This is the corner that will be located on the umbrella frame at the point closest to the mast.
- Step 3** Locate the centre/apex of the fabric canopy with the hole & circular support ring.
- Step 4** With the umbrella frame semi-open, using a step ladder or something similar to safely access the top of the umbrella, spread the fabric canopy over the top of the umbrella frame, positioning the hole that is in the centre of the fabric canopy directly over the upper hub (refer Fig 11, Step 5) of the frame.
- Step 5** While maintaining the position of the centre of the fabric canopy approximately as outlined in Step 4, orientate the fabric so that the corner with the oval brass / nickel eyelet (mentioned in Step 2) is positioned over the Lower Main Spar attached to the mast.
- Step 6** Once the fabric canopy is orientated to its correct position, proceed with inserting the ends of the individual frame struts each into its own relevant fabric pocket located around the underside perimeter of the fabric canopy.

* Please note: As the fabric canopy is made to fit relatively taut over the frame, the last 2-4 struts to be inserted into their pockets may take more effort than the first ones. At the point where each pocket is located, pull the edge of the fabric canopy down with sufficient force to enable the spoke to slot into its pocket.

- Step 7** Take the corner of the fabric canopy with the oval brass / nickel eyelet (as mentioned in Step 2) and fit it over the turn button fastener fixed to the upper surface of the Lower Main Spar (refer Fig 11, Step 6). Turn the turn button fastener so the eyelet & canopy are locked in place. Ensure the Velcro fabric overlap up the length of the main spar and the 'chute' where the upper main spar protrudes through the fabric canopy are correctly fitted and positioned.
- Step 8** Return the umbrella to fully closed position, then using a step ladder or something similar to safely access the top of the umbrella, ensure that the hole in the centre of the fabric canopy is directly over the threaded hole in the upper frame hub (refer Fig 11, Step 5). Bolt the fabric canopy cap firmly in position over the top of the fabric, as shown below.

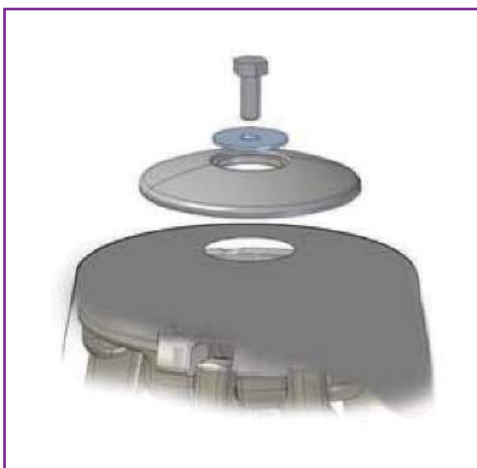

3D) CONNECTING THE LED LIGHT (optional accessory):

The LED Lights which are an optional accessory offered for the SU7 Umbrella are fitted to the centre lower hub of the umbrella at the time of manufacture (see Figure 12).

Figure 12 - LED Lights



As part of the umbrella assembly process, if your umbrella has the optional LED lights fitted, the electrical cable connected to the LED Light which is incorporated within the umbrella frame will require connecting to the Control Box Unit (supplied) which in turn will require connecting to an external 230/240V power supply.

IMPORTANT NOTE! Any 230V/240V wiring for electrical connections must be carried out and certified by a qualified electrician.

HANDY TIP! Steps 1 - 3 of this Connecting LED Lights process are best done between Steps 7 and 8 of the main assembly process (3A - Assembling The Umbrella).

Step 1 Unscrew the lid off the Control Box Unit and remove the electrical circuit board from the base of the plastic casing box. (See Figure 13)

HANDY TIP! The electrical circuit board may be wedged in the base of the plastic casing box quite tightly but can be gently levered out with the help of a screwdriver or similar.



3E) FITTING THE LED LIGHT SYSTEM (Optional Accessory)

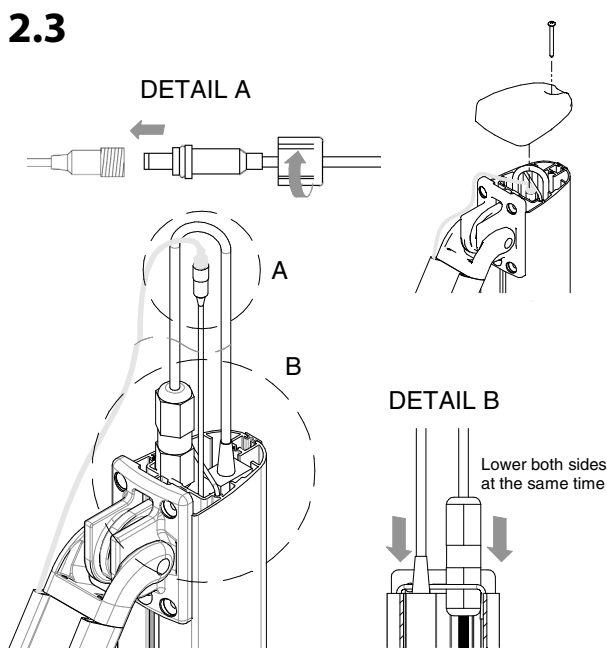
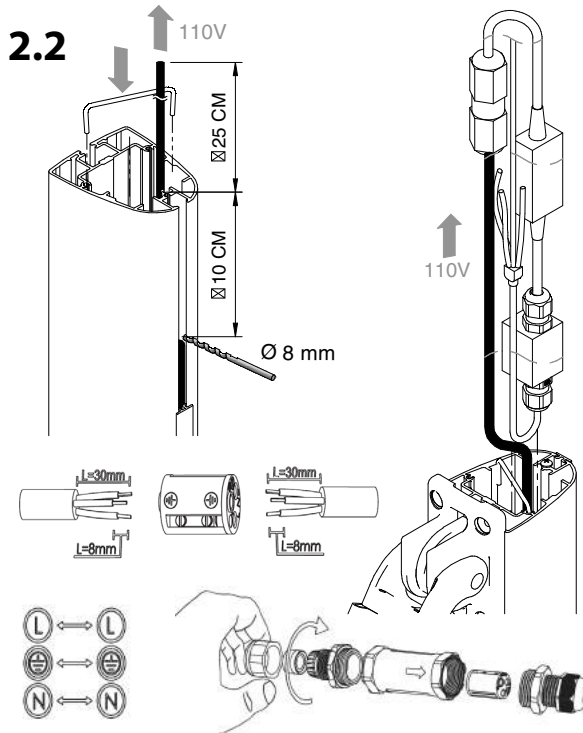
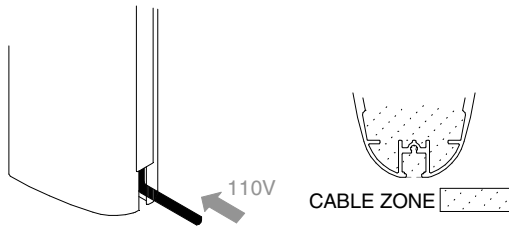

2. MOUNTING LED KIT SU7 110V

2.1. Mounting the 110 V power cable

- STEP 1** The power cable can be put into the provided channel behind the pole or into the central part of the pole.
- STEP 2** Remove the back cover profile of the pole in order to reveal the power cable.
- Caution:** The provided areas for the power cable are indicated. Please only use these zones to insert the cable.

2.2. Connecting the 110V power cable

- STEP 1** Put the cable into the provided channel. Drill a hole of 8mm (or according to cable thickness) at approximately 10cm of the top. The power cable can then be guided upwards into the pole through this hole.
- STEP 2** The power cable needs to stick out about 25cm at the top of the pole in order to make the connection. The total needed cable length measured as from the floor is 3m.
- STEP 3** Unscrew the connector so that the internal parts appear.
- STEP 4** The LED kit is already connected to the connector. The power cable should be connected to the other side of the connector by using a small screwdriver.
- Caution:** Make sure to always connect matching cables L-L / N-N / PE-PE
- STEP 5** Once the connection is made, close the connector by using wrenches size 24.
- Caution:** Make sure the connector is closed tightly after connecting. This guarantees a waterproof connection.

2.3. Connecting LED cable & mounting LED kit

- STEP 1** In order to lower the LED kit into the pole, grab it in one hand, the transparent cable facing down and the black power cable facing up. Make sure that the transparent female connector of the LED cable goes back upwards along the LED kit. Grab the connector into the other hand. Lower both parts, each at one side of the metal bracket, into the pole. (Detail B). This way, the LED kit is suspended over the metal bracket with the power cable.
- STEP 2** Connect the female connector of the LED kit coming out of the pole to the male connector of the LED cable coming out of the frames like indicated on DETAIL A. Close them tightly to guarantee a waterproof connection.
- STEP 3** Put the top cover on the pole by using the supplied screw

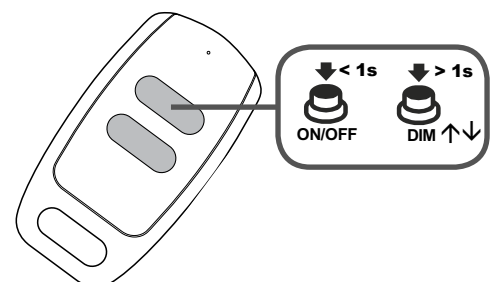

Remote memorization of further radio codes

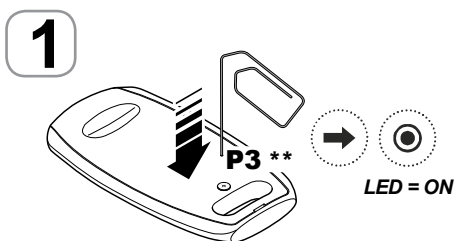

Press the button of the transmitter.

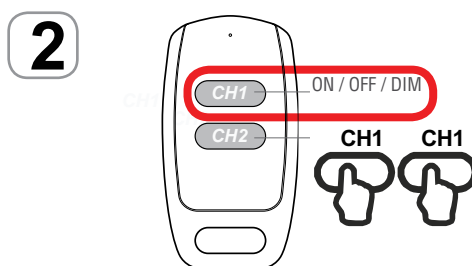

Press CH1 button twice of the transmitter.

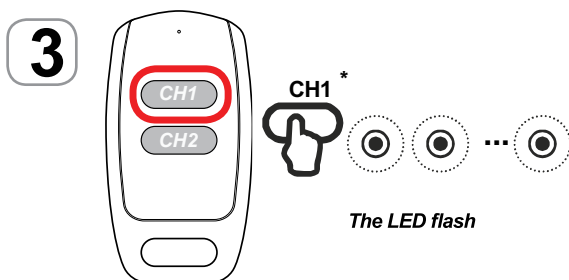

Press the CH1 button once for the transmitter to memorise.

Remote deletion of a radio code

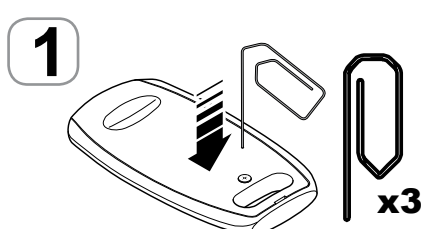

Press the button three times of the memorized transmitter.

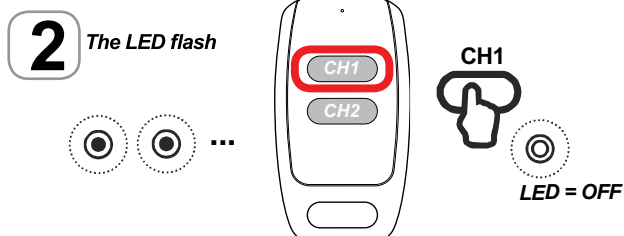

Press the CH1 button once for the transmitter to delete.

40W Transformer included

Power supply	100-277V~
Max power output	40W
Operating temperature range	t.a. 50°C
Protection: short circuit, overload and overheating	
The product is exclusively designed for LED loads	



STAGE 4 Operating the Umbrella

The SU7 Umbrella is designed to be operated by one person.

The gas-strut allows the umbrella to be opened and closed in one easy sliding movement. Simply release the sliding wagon by rotating the locking grip anticlockwise (see Figure 16) and push the sliding wagon up the mast until it hits the stopper screw.

HANDY TIP! Due to the stopper screw being of minor detail it is often overlooked when assembling the umbrella. You can insert it now if you haven't already. The stopper screw is included in the parts kit.

The hole for the stopper screw is located approx 500mm below the top of the mast and inside the trolley track (see Figure 11, Step 12).

At the point where the sliding trolley makes contact with the stopper the umbrella should be fully extended and the fabric canopy should be firm and taut.

Secure the sliding wagon by twisting the locking grip clockwise.

This procedure should take no more than a few seconds (see Figure 16).

To close the umbrella simply release the locking grip (turn anti-clockwise), slide the trolley down the mast until the umbrella is fully closed and tighten the locking grip (clockwise) once again.

For more information on how to operate your umbrella please visit our website and view the SU7 product demonstration video. You can view these videos at any time by visiting www.shadowspec.com/videos

Figure 16 - Raising and lowering the umbrella

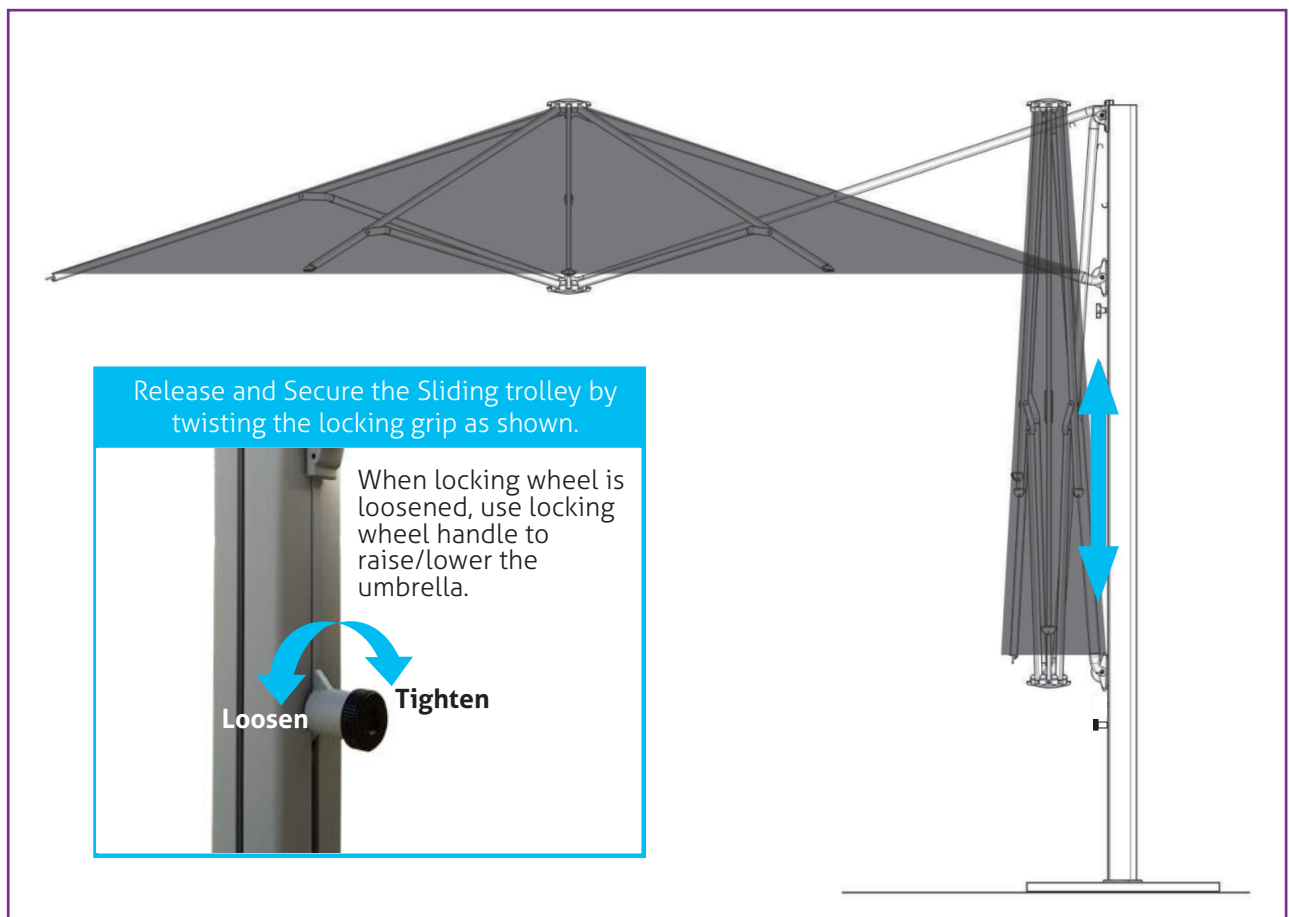

SECTION 2 – Umbrella Care and Maintenance

Regular care and maintenance of your umbrella is essential.

The following points will assist in keeping it looking smart and clean while also ensuring its ongoing performance and reliability.

- Always place the Protection Cover over the umbrella when not in use.
- Close and cover your umbrella in adverse conditions, this includes rain, snow, hail and high wind.
- Take care when opening or closing the umbrella, always check for obstacles first (ie: trees, ladders, furniture, people).
- Umbrella should never be left stored/collapsed for long periods while wet. Always ensure that the fabric is thoroughly dried before storing or closing for long periods of time.
- Any early signs of mould or mildew must be removed immediately.
- Umbrella canopy is removable and fully washable. Clean fabric using cold or warm water and mild natural soap. Always rinse thoroughly and leave to dry in the open air – **do not** put in clothes dryer.
- Never clean any part of the umbrella with a corrosive/abrasive product or a high pressure hose.
- Never use waterproofing or cleaning sprays on umbrella fabric without seeking appropriate advice first.
- All moving parts on the umbrella are best maintained with an annual application of dry lubricator, such as dry contact silicone spray.

FABRIC CLEANING INSTRUCTIONS:

SHADOWSPEC Umbrella canopies are manufactured from some of the most durable and state-of-the-art marine fabrics and threads available, including Sunbrella and Dickson-Constant acrylic fabrics, along with other proven high-performance, UV stable materials. SHADOWSPEC Umbrella canopies should be cleaned regularly before dirt is allowed to accumulate and become embedded in the fabric. The fabric canopy can be cleaned without being removed from the frame, however, the canopy can be completely removed from the frame if preferred. Simply brush off any loose dirt or particles, hose down and clean with a mild soap in lukewarm water (no more than 98° F.) Rinse thoroughly to remove soap. Allow fabric to air dry. Do not use heavy detergents.

For stubborn stains, '303' Fabric Cleaner is recommended although as with any cleaner, it is advisable to trial a small area of the fabric first to ensure no adverse effect or discolouration occurs.

Following cleaning it is also then advisable to re-treat the fabric with a water repellency application again. We recommend '303' Protectant for this purpose.

When washing or cleaning, DO NOT SUBJECT TO EXCESSIVE HEAT as the fabric will shrink. DO NOT STEAM PRESS OR DRY IN ELECTRIC OR GAS DRYERS, but allow air to dry. In cases where the umbrella is taken down and stored during the winter season, the canopy should be cleaned, allowed to air dry, and stored in a dry, well ventilated area. A Protection Cover should be used at all times when umbrella is not in use to ensure the longest serviceable life.





SECTION 3 – Warranty

SHADOWSPEC umbrellas are produced with the greatest care and meet the strictest quality standards.

THE SHADOWSPEC WARRANTY

Unicrest Group Ltd guarantees that Shadowspec umbrellas that are installed in accordance with our guidelines will be free of defects in materials and workmanship for the period of time as set out and specified in the table below:

	Umbrella Fabric	Umbrella Frame
Shadowspec SU2	2 Years	4 Years
Shadowspec SU3	2 Years	2 Years
Shadowspec SU4	3 Years	3 Years
Shadowspec SU6	5 Years	5 Years
Shadowspec SU7	5 Years	5 Years
Shadowspec SU10	5 Years	3 Years

*‘Fabric’ warranty relates to the umbrella fabric canopy. Protection Cover warranty is 2 years for all models

Please note: All time periods as specified in the above table are applied from the date of invoice.

In the case of commercial applications, the guarantee shall be a period of 2 years or the above specified period (whichever is the lesser) from the date of the invoice.

The obligation of Unicrest Group Ltd under this guarantee is limited to faulty manufacturing, defective materials and mechanical failure when the umbrella has been used and cared for appropriately from the date of invoice. If an umbrella is repaired under guarantee the guarantee period will not be extended.

Unicrest Group Ltd shall, at its sole discretion, determine whether repair or replacement is appropriate.

This warranty does not cover the following:

- Damage caused by an accident, negligence, storm, wind, accumulation of water or snow, incorrect installation, not following the maintenance instructions, incorrect use or natural ageing and fading.
- Damage caused by exposure to hazardous atmospheric situations due to industry or a high slat level.
- Small colour variations between the fabric and the colour samples and between the components and profiles, which are caused by the manufacturing process.
- Damage to a third party.
- Repair costs by a third party.

To avoid possible wind damage, it is recommended that your SU7 umbrella be closed in wind gusts exceeding 40km/h. This is subject to the umbrella being sufficiently anchored.

This warranty does protect against the umbrella canopy fabric becoming unserviceable due to strength loss from normal usage and exposure conditions.

The foregoing sets out the extent of this guarantee.

Unicrest Group Ltd shall not otherwise be liable or responsible for any direct, indirect, incidental or consequential damage, costs or losses of any kind arising out of or in connection with the umbrella or components or for any delay by Unicrest Group Ltd or the component manufacturer in undertaking repairs or replacement under this guarantee.

Except as expressly provided herein, all other warranties, representations, conditions, undertakings, rights, duties or liabilities, whether arising by implication of law or otherwise, are hereby expressly excluded.

If you need to make a warranty claim, please contact Unicrest Group Ltd directly or via the agent you purchased through.

New Zealand

Ph: 0800 144 155

Email: info@shadowspec.co.nz

www.shadowspec.co.nz

Australia

Ph: 1800 144 155

Email: info@shadowspec.com.au

www.shadowspec.com.au

USA

Ph: 844 888 5577

Email: info@shadowspec.com

www.shadowspec.com





shadowspec

umbrellas with distinction

Contact our in-house shade and outdoor specialists
for more information and advice.

AUSTRALIA

Australian Nest
Laverton North, Victoria
1800 144 155
www.shadowspec.com.au

NEW ZEALAND

Heron Base
Whangarei, Northland
0800 144 155
www.shadowspec.co.nz

UNITED STATES

North American Nest
Atlanta, Georgia
844 888 5577
www.shadowspec.com